

DESIGNED FOR USE WITH RG 316/U & SIMILAR CABLES	
CABLE ENTRY DIAMETER MINIMUM	
HOUSING	.066
FERRULE	.125
CONTACT	.023

REVISIONS		DATE	APPROVED
REV	DESCRIPTION		
02	REVISED	4/28/93	IC 5/4/93
B	REVISED PER 0020-0262-01	G.V. 4/28/93	JGH

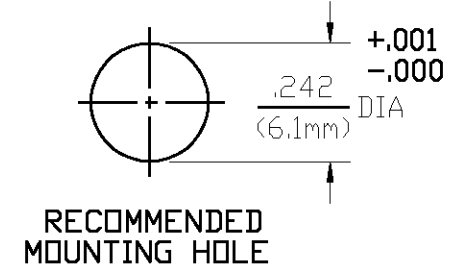

ELECTRICAL	MECHANICAL	ENVIRONMENTAL
Nominal Impedance (Ohms) <u>50</u>	Interface Dimensions Per DESC Dwg 85074	TEMPERATURE RATING <u>-65° TO +125°C</u>
Frequency Range (GHz) DC to <u>3</u>	Force to Engage (In-Lbs MAX) <u>3.0</u>	Vibration MIL-STD-202, Method 204, Condition D
Volt Rating (VRMS MAX) @ Sea Level <u>250</u>	& Disengage (In-Lbs MAX) <u>1.5</u>	Shock MIL-STD-202, Method 213, Condition I
VSWR <u>1.15+0.02f(GHz)</u> DC to 3 GHz	Center Contact Captivation Axial (Lbs) <u>6.0</u>	Thermal Shock MIL-STD-202, Method 107, Condition B
Insertion Loss (dB MAX) <u>.03x√f(GHz)</u>	Cable Retention Axial Force (Lbs MIN) <u>20.0</u>	Except High Temp Shall Be +115°C
RF Leakage (dB MIN) (Fully Mated) <u>-85-f(GHz)</u>	Weight (Grams) <u>TBD</u>	Moisture Resistance MIL-STD-202, Method 106, Except Step 7b
Corona, 70,000 Ft (VRMS MIN) <u>190</u>		Shall Be Omitted
Dielectric Withstanding Voltage (VRMS MIN) @ Sea Level <u>750</u>		Corrosion - MIL-STD-202, Method 101, Condition B
Contact Resistance (Milliohms MAX)		
Center Contact <u>3.0</u>		
Outer Contact <u>2.0</u>		
Cable to Housing <u>0.5</u>		
RF High Potential @ Sea Level (VRMS MIN @ 5 MHz) <u>500</u>		
I.R.(Megohms MIN) <u>5000</u>		

COMPONENT	MATERIAL	FINISH
HOUSING MOUNTING NUT LOCKWASHER	STAINLESS STEEL PER ASTM-A484 AND ASTM-A582, TYPE 303	PASSIVATE PER ASTM-A380
DIELECTRIC	TFE FLUOROCARBON PER ASTM-D-1457	N/A
CENTER CONTACT	BERYLLIUM COPPER PER ASTM B 196, ALLOY C17300, CONDITION H	GOLD PLATE PER MIL-G-45204 OVER COPPER PLATE PER MIL-C-14550
*O - RING	FLUOROSILICONE PER MIL-R-25988, CLASS I, TYPE I.	N/A
SHRINK TUBING	HEAT SHRINKABLE POLYOLEFIN COMPOUND MIL-I-23053/4	N/A
FERRULE	COPPER OR BRASS ALLOY ROCKWELL F65 MAXIMUM	GOLD PLATE PER MIL-G-45204 OVER COPPER PLATE PER MIL-C-14550

UNLESS OTHERWISE SPECIFIED DIMENSIONS ARE IN INCHES TOLERANCE ON	DRAWN BY K.C.MAHER	DATE 1/29/88		AMP Incorporated 140 Fourth Avenue Waltham, MA 02451-7599	
	FRAC. DEC. ANGLES	CHECKED BY MH/M			DATE 2-10-88
± 1/64 ±.005 ± 1°	APPROVED BY BAR	DATE 2-11-88	TITLE DSP BULKHEAD FEEDTHROUGH CABLE PLUG - CRIMP ATTACHMENT		
These drawings and specifications are the property of Densit Spectra Incorporated and shall not be reproduced or copied or used in whole or in part as the basis for the manufacture or sale of item(s) without written permission.	USE ASSY PROCEDURE 408-04611 (45-154) NO. A.P. _____	SIZE B	CODE IDENT NO. 26805	4533-5007-02	REV 02
SCALE 3:1			SHEET 1 OF 1		

CUSTOMER DRAWING

AMP PART # 1059518-1  
SHEET 1 OF 1 REV B